



VELOCITYONE™ FLIGHTSTICK

UNIVERSAL SIMULATION CONTROLLER | MANETTE DE SIMULATION UNIVERSELLE

PILOT'S OPERATING HANDBOOK

IMPORTANT: READ BEFORE USING
ANY QUESTIONS? [TURTLEBEACH.COM/SUPPORT](https://www.turtlebeach.com/support)

CONTENTS

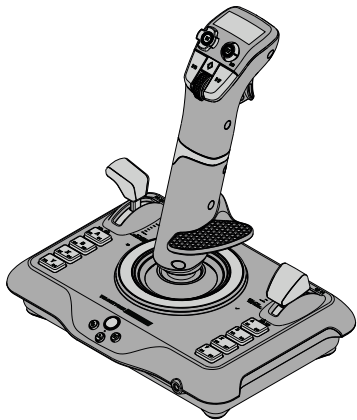

A VELOCITYONE FLIGHTSTICK

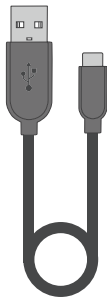

B 10'3 M USB-A TO USB-C CABLE



C M5 COCKPIT FIXING SCREWS X3

- 1 Auxiliary connection ports*
- 2 Xbox & pc usb-c connection port
- 3 Multi-function levers with 2 detent buttons
- 4 Digital 8-way pov
- 5 Flight management display
- 6 Trigger
- 7 Analog pov with click press
- 8 Microswitch buttons (b16-b17)
- 9 Buttons (b1-b4)
- 10 Buttons (b5-b8)
- 11 Xbox navigation controls
- 12 3.5mm headset port

- 13 Hall effect sensing stick with rudder twist
- 14 Trim wheel
- 15 Fmd configurator wheel
- 16 Touchpad with click press
- 17 Adjustable wrist rest

*To be used for future VelocityOne peripherals. Currently, there are no additional products to use in the ports. When available, we will issue a firmware update to the product to enable use with additional accessories in our range.

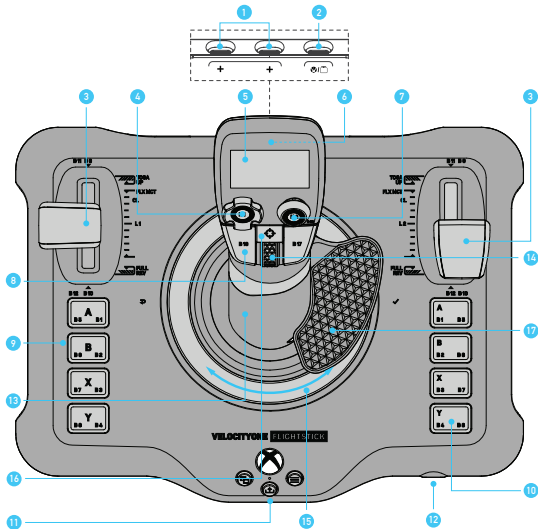

HARDWARE SETUP

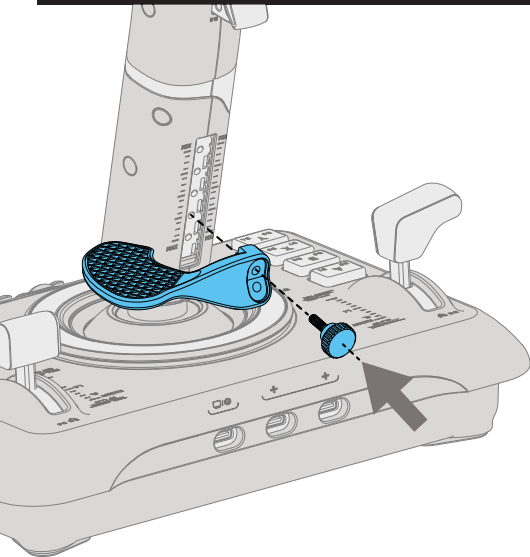

The wrist rest can be adjusted for left or right-handed use. It can also be raised or lowered to suit your hand size. Remove the securing screw, move the wrist rest into your preferred position and then tighten the screw.

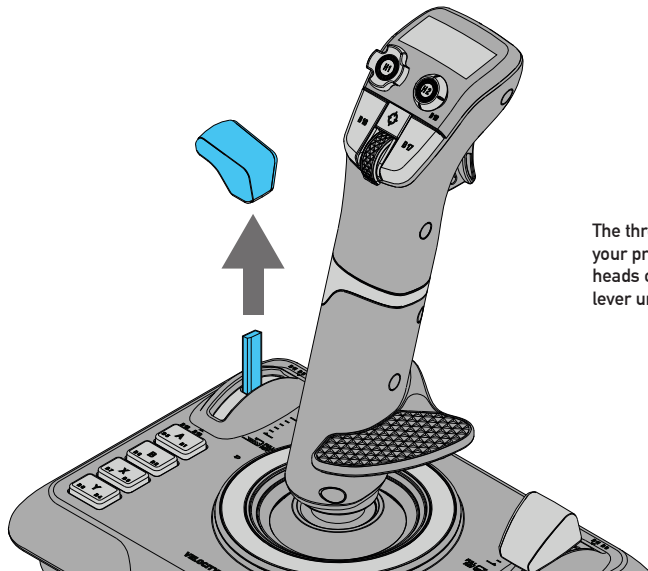

The throttle heads can be swapped to suit your preferences. Simply pull the throttle heads off and then push back on to the lever until they click.

CONNECTING A HEADSET



Connect a 3.5 mm headset
for use on Xbox and PC.

FLIGHT MANAGEMENT DISPLAY (FMD)

The Flight Management Display (FMD) allows you to configure your controller on-the-fly. It has a dedicated configuration wheel. Rotate the wheel to cycle through menu options and adjust product settings. Click the right side of the wheel [✓] to select an option or accept a settings change. Click the left side of the wheel [↶] to navigate back to the home screen.

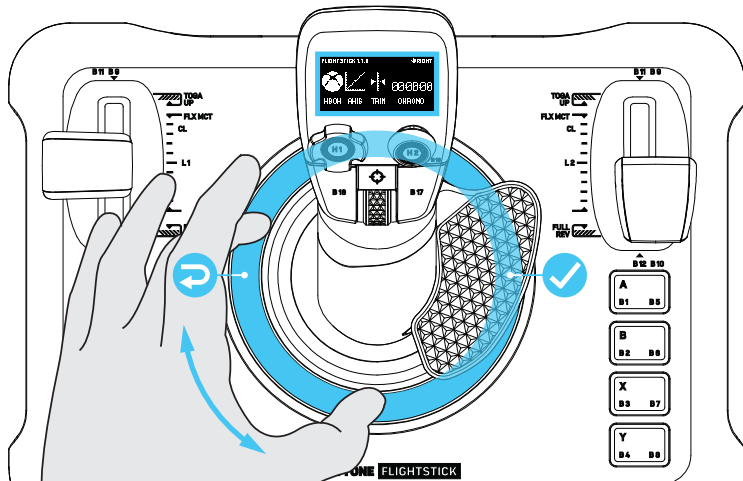

CONNECTING TO XBOX

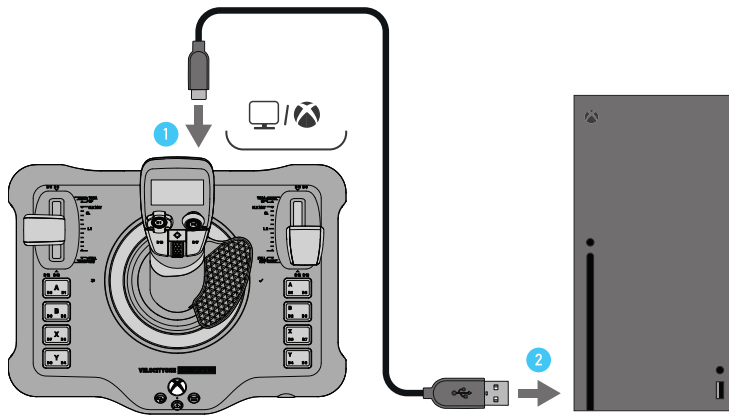

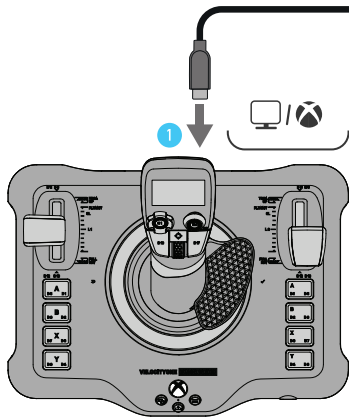

The Flightstick will be in Xbox mode by default. To switch input modes, rotate the Configurator Wheel, then right-click the wheel to select Input Mode. Rotate the wheel again to select PC, and then click the wheel to set your input mode. The mode will be stored in memory for next time you use the controller.

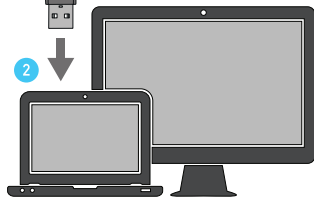

XBOX NAVIGATION

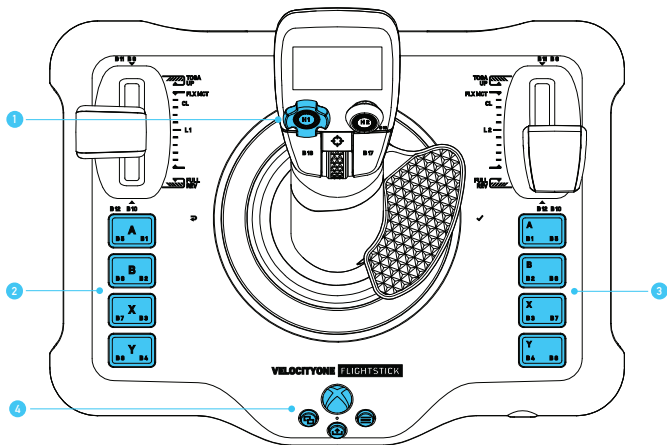

You can navigate your Xbox system using the controls on the Flightstick.

- 1 D-PAD**
Select menu items.
- 2 FACE BUTTONS**
Accept, Back and other system options (Right-handed mode)
- 3 FACE BUTTONS**
Accept, Back and other system options (Left-handed mode)
- 4 XBOX CONTROLS**
Change view, share your content and open menus. Open Guide on Xbox

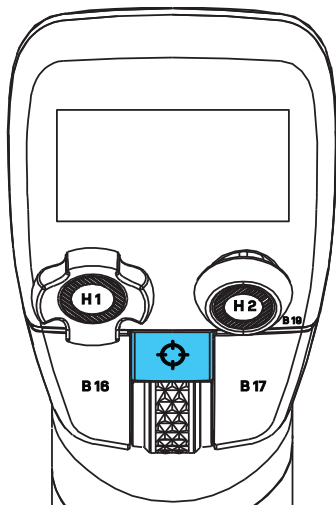

In PC Mode the Touchpad can be used to control the mouse cursor. Clicking the Touchpad will replicate the left-click of a mouse.

FMD - HOME SCREEN

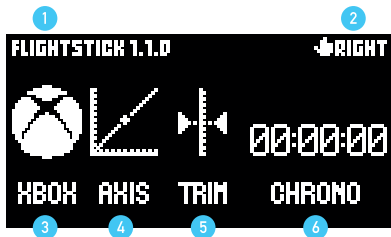

- 1 Current firmware version
- 2 Stick orientation
- 3 Input mode
- 4 Current active axis profile
- 5 Trim wheel position
- 6 Chronometer

Home Screen provides an overview of the current stick configuration. It shows the current input mode, axis profile, trim mode and orientation. It also serves as a chronometer for timing your flight waypoints. Simply right-click the configuration wheel to start/stop the timer and left-click the configuration wheel to reset the timer.

To access the main menu, rotate the wheel to delve deeper into the options.



Stick Performance gives you the ability get live feedback from the stick via the Test option and adjust axis response curves via the Profile option.

Profiles come in three versions:

- STANDARD - Unaltered input data for true 1:1 control.
- PRECISION - Make fine adjustments with larger movements ideal for tense landings.
- FAST - Quicky snappy movement ideal for arcade style control.

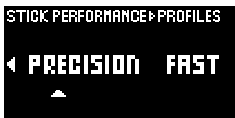
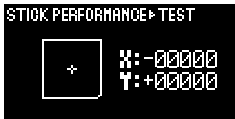

FMD - AUDIO

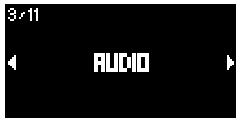

Access full control of audio on Xbox and PC. Adjust game volume, Chat Mix*, Mic Monitoring and Mic Status without pausing your flight. Enhance your experience by choosing one of 5 Turtle Beach Audio presets, including Superhuman Hearing. *Chat Mix will only work on Xbox consoles.

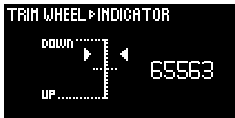

This feature gives you the ability get live feedback from the Trim Wheel via the Indicator option and input preference via the Response option.

The Trim Wheel comes in in two versions:

- **ANALOGUE AXIS** Gives precision control for aircraft that use wheel based trim controls.
- **DIGITAL BUTTONS** The wheel will out two button pulses depending on what direction it is moved in. Ideal for aircraft that use button based trim controls.



Rudder lock blocks the input from the twist action of the stick. This can be used in situations where yaw control is not required, or if the stick is being used in conjunction with a set of Rudder Pedals.



Integrated from our range of console controllers, the Pro Aim feature helps to temporarily reduce the sensitivity of the main stick axes. This is useful for making critical in-flight adjustments or honing your aim on an enemy fighter.

The Set Button option enables any of the programmable buttons to be set to initiate the Pro Aim feature. The assigned button must be pressed and held. Note any previously assigned functions to the button will also be output at the same time as Pro Aim.

The Set Level option tunes the total reduction in sensitivity, when the assigned Pro Aim button is pressed. The higher the setting the larger the reduction in sensitivity.



In conjunction with the adjustable wrist rest, the Orientation feature helps improve the Flightstick experience whether you are right or left-handed.

By default, the product is set for Right-handed operation. When set to Left-handed operation, the underlying button and axis mappings of the base controls swap sides. This means if you operate the stick with your left hand, you can still easily access the ABXY controls and primary throttle control with your Right hand. Avoiding the need for uncomfortable hand movements, or time-consuming profile adjustments.

Once your input preference is set, it will be displayed on the Home Screen for easy reference.



Adjusts the overall sensitivity response of the touchpad cursor input. The range is from low to high, with the top value being very fast movement, and the lowest being no movement at all.

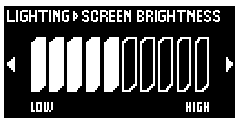

Customize the look of the product by selecting from a range of colour themes. Also tune the brightness of the LEDs and the FMD to your preference.



Connect the Flightstick to a compatible smart device via Bluetooth and use the companion app to enable real-time customization of product features. Smart device companion app requires Android 8.0, iOS 15.4 or later.

EXPANSION PORTS

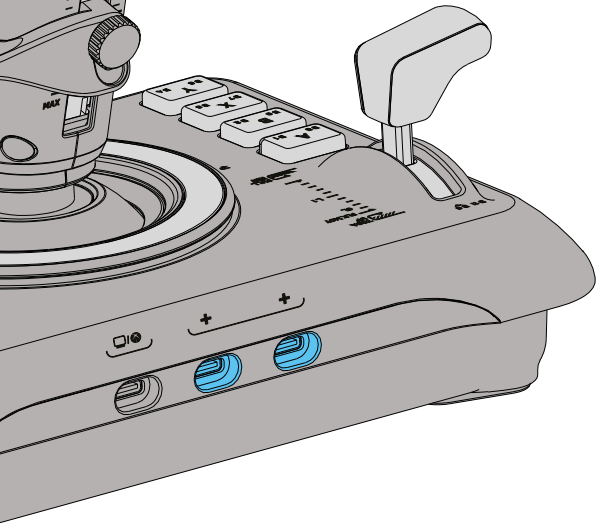

The product includes two additional USB-C ports next to the main connection port. These are expansion ports to be used for future VelocityOne peripherals. Currently, there are no additional products to use in the ports. When available, we will issue a firmware update to the product to enable use with additional accessories in our range.



Search for Velocityone Flightstick Companion App on
Microsoft Store, Play Store and App Store.
Smart device companion app requires Android 8.0, iOS 15.4 or later.

Not seeing what you're looking for here?
Visit turtlebeach.com/support for the latest Tech Support information.

Regulatory Compliance Statements for the Velocityone Flightstick

Local Restrictions on Radio Usage

Caution: Due to the fact that the frequencies used by wireless devices may not yet be harmonized in all countries, these radio products are designed for use only in specific countries, and are not allowed to be operated in countries other than those of designated use. As a user of these products, you are responsible for ensuring that the products are used only in the countries for which they were intended and for verifying that they are configured with the correct selection of frequency and channel for the country of use. Any deviation from the permissible power and frequency settings for the country of use is an infringement of national law and may be punished as such.

To determine whether you are allowed to use your wireless network device in a specific country, please check to see if the radio type number that is printed on the identification label of your device is listed in the manufacturer's OEM Regulatory Guidance document at the following URL <http://www.turtlebeach.com/homologation> or contact Turtle Beach directly.

Federal Communications Commission (FCC) Compliance Notices

This section includes the following FCC statements for the Velocityone Flightstick:

- Non-Modification Statement
- Class B Interference Statement
- RF Radiation Exposure & Hazard Warning

Caution: Any changes or modifications not expressly approved by the party responsible for compliance could void the user's authority to operate this equipment.

FCC Caution:

This device complies with part 15 of the FCC Rules. Operation is subject to the following two conditions:

(1) This device may not cause harmful interference, and (2) this device must accept any interference received, including interference that may cause undesired operation. Any Changes or modifications not expressly approved by the party responsible for compliance could void the user's authority to operate the equipment.

Note: This equipment has been tested and found to comply with the limits for a Class B digital device, pursuant to part 15 of the FCC Rules. These limits are designed to provide reasonable protection against harmful interference in a residential installation. This equipment generates uses and can radiate radio frequency energy and, if not installed and used in accordance with the instructions, may cause harmful interference to radio communications. However, there is no guarantee that interference will not occur in a particular installation. If this equipment does cause harmful interference to radio or television reception, which can be determined by turning the equipment off and on, the user is encouraged to try to correct the interference by one or more of the following measures:

- Reorient or relocate the receiving antenna.
- Increase the separation between the equipment and receiver.
- Connect the equipment into an outlet on a circuit different from that to which the receiver is connected.
- Consult the dealer or an experienced radio/TV technician for help.

RF Radiation Exposure & Hazard Statements

This equipment complies with FCC radiation exposure limits set forth for an uncontrolled environment. End users must follow the specific operating instructions for satisfying RF exposure compliance. This transmitter must not co-located or operating in conjunction with any other antenna or transmitter.

RF warning for Portable device

The device has been evaluated to meet general RF exposure requirement. The device can be used in portable exposure condition without restriction.

Non-Modification Statement

Use only the supplied Internal antenna. Unauthorized antenna, modifications, or attachments could damage the Velocityone Flightstick and violate FCC regulations. Any changes or modifications not expressly approved by the party responsible for compliance could void the user's authority to operate this equipment. Please contact Turtle Beach for a list of approved 2.4 GHz antennas.

Innovation, Science and Economic Development Canada (ISED) Compliance Notices

This section includes the following ISED statements for Velocityone Flightstick:

- Class B Interference Statement
- RF Radiation Exposure & Hazard Warning

Canadian ICES Statements

RSS-Gen Issue 3 December 2010:

This device complies with Industry Canada's licence-exempt RSSs. Operation is subject to the following two conditions:

1. This device may not cause interference, and
2. This device must accept any interference, including interference that may cause undesired operation of the device.

CNR-Gen 3e édition Décembre 2010:

Le présent appareil est conforme aux CNR d'Industrie Canada applicables aux appareils radio exempts de licence. L'exploitation est autorisée aux deux conditions suivantes :

1. L'appareil ne doit pas produire de brouillage, et
2. L'utilisateur de l'appareil doit accepter tout brouillage radioélectrique subi, même si le brouillage est susceptible d'en compromettre le fonctionnement.

RF Radiation Exposure & Hazard Statement

The product complies with Canada portable RF exposure limits set forth for an uncontrolled environment and are safe for intended operation as described in this manual. The further RF exposure reduction can be achieved if the product can be kept as far as possible from the user body or set the device to lower output power if such function is available.

Exposition aux radiations RF & Mention de danger

Le produit est conforme aux limites d'exposition pour les appareils portables RF pour les Etats-Unis et le Canada établies pour un environnement non contrôlé. Le produit est sûr pour un fonctionnement tel que décrit dans ce manuel. La réduction aux expositions RF peut être augmentée si l'appareil peut être conservé aussi loin que possible du corps de l'utilisateur ou que le dispositif est réglé sur la puissance de sortie la plus faible si une telle fonction est disponible.

WARNING: This product can expose you to chemicals which are known to the State of California to cause cancer.

For more information, go to www.P65Warnings.ca.gov.

European Union and European Fair Trade Association (EFTA) Regulatory Compliance

This equipment may be operated in the countries that comprise the member countries of the European Union and the European Fair Trade Association. These countries, listed below, are referred to as The European Community throughout this document: AUSTRIA, BELGIUM, BULGARIA, CYPRUS, CZECH REPUBLIC, DENMARK, ESTONIA, FINLAND, FRANCE, GERMANY, GREECE, HUNGARY, IRELAND, ITALY, LATVIA, LITHUANIA, LUXEMBOURG, MALTA, NETHERLANDS, POLAND, PORTUGAL, ROMANIA, SLOVAKIA, SLOVENIA, SPAIN, SWEDEN, UNITED KINGDOM, ICELAND, LICHTENSTEIN, NORWAY, SWITZERLAND.

NCC警語:

取得審驗證明之低功率射頻器材，非經核准，公司、商號或使用者均不得擅自變更頻率、加大功率或變更原設計之特性及功能。
低功率射頻器材之使用不得影響飛航安全及干擾合法通信；經發現有干擾現象時，應立即停用，並改善至無干擾時方得繼續使用。
前述合法通信，指依電信管理法規定作業之無線電通信。
低功率射頻器材須忍受合法通信或工業、科學及醫療用電波輻射性電機設備之干擾。

Declaration of Conformity

Marking by this symbol: 

declares that this product is in compliance with the essential requirements and other relevant provisions of Directive 2014/53/EU.

Operation frequency: 2402-2480MHz, Max output: 5.21dBm

This equipment meets the following conformance standards:

FCC PART15B
FCC47 CFR Part 15:2019
TPCH(2021-2)
10 C.F.R. section 430.23(aa); Appendix Y to Subpart B of Part
ENERGY STAR Draft Test Method for Computers, Rev.
October 2019, California Code of Regulations, Title 20, Division 2, Chapter
CPSIA/H.R. 4040 Sec.108, CPSIA/H.R. 4040 Sec.101
EN 55032, EN55035
EN 71-1: 2014+A1 2018 Mechanical and Physical Test, EN71-2:2011+A1:2014 Flammability, EN 71-3:20 19 Toxic elements
EN300328, 301489, 62479
EN62368
SVHC 233+REACH Appendix 17 : VW 91101-2020
Total Cadmium Content (Entry 23 of REACH Annex XVII)
IEC 62321-7-2:2017,
IEC 62321-8:2017,
IEC 62321-4:2013+A1:2017,
IEC62321-6:2015,
IEC62321-5:2013,
94/62/EC Toxic Elements in Packaging
Polycyclic Aromatic Hydrocarbons (PAHs) (Entry 50 of REACH ANNEX XVII)
BPA (toy<3 or intended for place in the mouth)
IC RSS-247 Issue 2 Feb.2017
Canada IC test for toy with IC (ICES-003)

NRCAN, Appendix Z to Subpart B of Part 430
AS/NZS CISPR 32:2015+A1:2020
BS EN IEC62368-1:2012+A11:2020
USB 2.0 Full Speed Test
Bluetooth Certification

Please visit the following URL for a complete copy of the Declaration of Conformity: <http://www.turtlebeach.com/homologation>



This symbol on the product or its packaging indicates that this product must not be disposed of with your other household waste. Instead, it is your responsibility to dispose of your waste equipment by handing it over to a designated collection point for the recycling of waste electrical and electronic equipment. The separate collection and recycling of your waste equipment at the time of disposal will help conserve natural resources and ensure that it is recycled in a manner that protects human health and the environment. For more information about where you can drop off your waste for recycling, please contact your local authority, or where you purchased your product.

Voyetra Turtle Beach Inc. is obligated as a producer with a main activity of selling under The Producer Responsibility Obligations (Packaging Waste) Regulations 2007. To fulfil our obligation we are registered with Comply Direct and their Recycling Room. Here you will find advice and information on packaging waste management, recycling symbols and the waste hierarchy principles of reduce, reuse and recycle.

<https://www.complydirect.com/the-recycling-room/>



この装置は、クラスB機器です。この装置は、住宅環境で使用することを目的としていますが、この装置がラジオやテレビジョン受信機に近接して使用されると、受信障害を引き起こすことがあります。

取扱説明書に従って正しい取り扱いをして下さい。

VCCI - B

YVR
10000th St. Richmond BC
Canada V6V 1W6
Airport: Vancouver, 10000th
PAC 604 273 8338

LAX
1 World Way
Los Angeles, CA
Airport: Los Angeles, 1 World Way
PAC 310 344 2000

YYZ
100th St. Toronto ON
Canada M3J 1P3
Airport: Toronto Pearson, 100th
PAC 416 223 2338

JFK
1 World Trade Center
New York, NY
Airport: New York, 1 World Trade Center
PAC 212 512 2200

MEX
1000th St. Mexico City
Mexico 06700
Airport: Mexico City, 1000th
PAC 52 55 23 23 23



WWW.TURTLEBEACH.COM

TBS-0722-05-QSG-EN-A

GIG

1000th St. Toronto ON
Canada M3J 1P3
Airport: Toronto Pearson, 1000th
PAC 416 223 2338